

CHRISTIE

Barbecue Hood

The Evolution of the Safety Lid

ICON SERIES LARGE CABINET

with our CC2
Electric Cooktop
and barbecue hood

| | Barbecue Hood Model | |
|----------------------------|---------------------|--------|
| | Electric | Gas |
| Width | 605 mm | 605 mm |
| Length | 630mm | 630 mm |
| Height (including bracket) | 130 mm | 140 mm |
| Height (above cooktop) | 75 mm | 75 mm |



+61 3 9708 2999
dachristie.com

Christie Barbecue Hood

The new Christie Barbecue Hood is a practical evolution of our popular safety lid, with enhanced benefits beyond protecting the hotplate from dirt. Tough and durable, it is specifically designed to complement the functionality and performance of your Christie CC2 and CC3 cooktop.

Constant torque hinges hold the hood open at every position above 45 degrees – allowing seated users of all abilities to open and close the lid during the cooking process.

The curved design, in combination with the recessed hotplate, creates ample clearance to cook with the hood down. This traps radiant heat, thus reducing power consumption, allowing you to cook faster, and enhancing the flavour of the cooked food. The sleek stainless steel outer surface is easy to clean, while the inner aluminium panel reflects heat back to the food on the hotplate during the cooking process.

Trapping radiant heat not only improves the overall cooking experience, it also keeps the outer surface of the hood from reaching harmful temperatures – in fact you can safely touch the hood during any stage of the barbecue cooking cycle.

Features and benefits

Tough, durable Glass Reinforced Nylon handle remains cool to the touch at all times

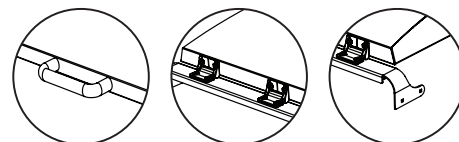

Soft close hinges and rubber bumpers for quiet operation and reduced wear and tear